

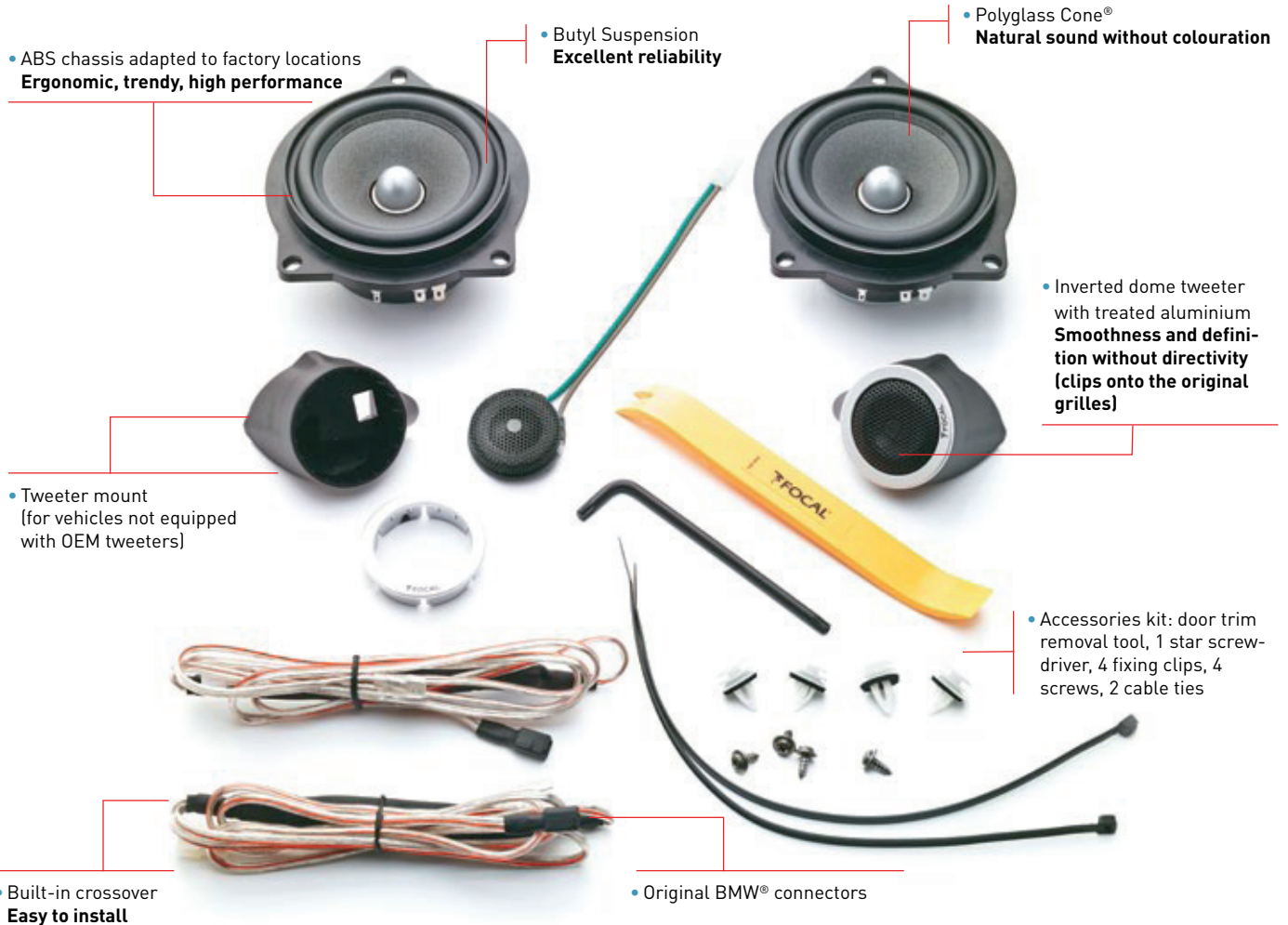

## 2-way component kit



## KEY POINTS

- 100% plug and play (original connectors)
- Compatible with 1 Series, 3 Series and X1
- Quick installation
- Improving systems not equipped with tweeters
- Significant results even without changing the OEM system
- Scalability in case of amplification or replacement of the head unit
- Complete pack (tools and clips supplied)
- Installation video tutorial (ref. QRcode)



## TECHNICAL SPECIFICATIONS

**Woofer:** 3<sup>15</sup>/<sub>16</sub>" (100mm)  
**Voice coil diameter:** 1" (25mm)  
**Voice coil height:** 0<sup>7</sup>/<sub>16</sub>" (11mm)  
**Magnet:** 2<sup>13</sup>/<sub>16</sub>" (72mm)

**Aluminium/magnesium inverted dome tweeter**  
**Crossover:** 18 dB/oct (4 kHz)  
**Max. power:** 80W

**Rms. power:** 40W  
**Sensitivity (2.83V/1m):** 90.5dB  
**Frequency response:** 85Hz – 22kHz  
**Nominal impedance:** 4Ω



## 2-way coaxial kit



### KEY POINTS

- 100% plug and play (original connectors)
- Compatible with 1 Series, 3 Series and X1
- Quick installation
- Compatibility and improvement of the original acoustics at the front or the rear
- Significant results even without changing the OEM system
- Scalability in case of amplification or replacement of the head unit
- Complete pack (tools and clips supplied)
- Installation video tutorial (ref. QRcode)



### TECHNICAL SPECIFICATIONS

**Woofer:** 3<sup>15/16</sup>" (100mm)  
**Voice coil diameter:** 1" (25mm)  
**Voice coil height:** 0<sup>7/16</sup>" (11mm)  
**Magnet:** 2<sup>13/16</sup>" (72mm)

**Aluminium/magnesium inverted dome tweeter**  
**Crossover:** 18 dB/oct (4 kHz)  
**Max. power:** 80W

**Rms. power:** 40W  
**Sensitivity (2.83V/1m):** 90.5dB  
**Frequency response:** 85Hz – 22kHz  
**Nominal impedance:** 4Ω

**VK Preis € 259,-**



Instant gratification



Integration

IFBMW-SUB

# PLUG&PLAY IFBMW-Sub



Flat subwoofer dedicated for BMW<sup>®</sup> - 8" (200mm)



- Steel/mesh grille  
**Subwoofer protection (under the seat location)**



## KEY POINTS

- Easy to install
- BMW<sup>®</sup> connector
- Factory look and OEM design
- Power handling with an amplifier - High performances
- Car compatibility\* BMW 1 Series (E81/82/87/88), BMW 3 Series (E90/91/92/93), BMW X1 (E84)

\*Upgrade for BMW<sup>®</sup> factory standard level. Non-exhaustive list of vehicles.  
Possibilities of adaptation in other models.

## TECHNICAL SPECIFICATIONS

**Subwoofer:** 8" (200mm)  
**Voice coil diameter:** 1<sup>9</sup>/<sub>16</sub>" (40mm)  
**Cone :** Reinforced polypropylene  
**Impedance:** 3,6 Ohms

**Max. power:** 180W  
**RMS. power:** 90W  
**Sensitivity (2.83V/1m):** 90.5dB  
**Frequency response:** 38Hz – 200Hz

**Accessoires :** Supplied with grille